

Placing or replacing a SAM

Instructions:

An instructional video can be found at: <https://www.youtube.com/watch?v=oWWyDIIKCzw&t=2s>

Open SAM Hatch

Open up the hatch that states SAM MODULES (small Philips head screwdriver is required). The cover is located on the backside of the terminal.

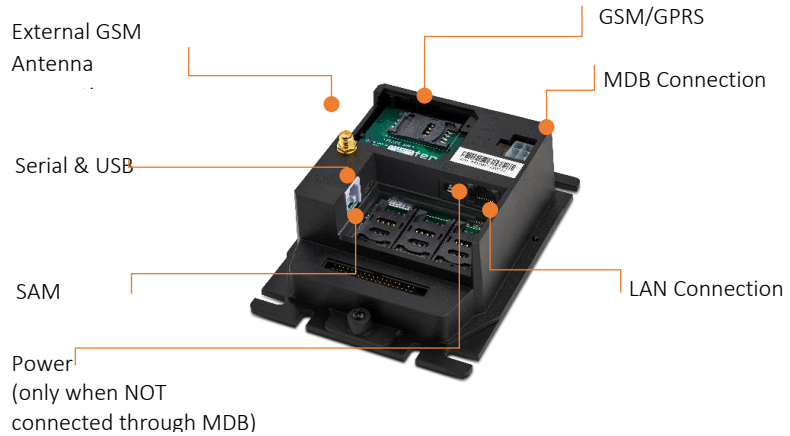
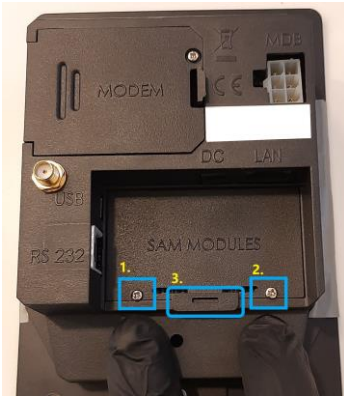

Open slider

Open up the slider that holds the SAM card. To slide it open, gently press against the SAM slot and slide to the bottom with care. This works the same as old mobile phones.

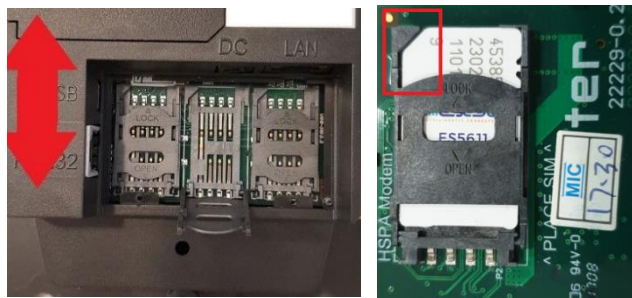

When placing the SAM(s), make sure that the SAM card is appropriately placed as shown in the image.

There is NO specific order in which multiple SAM cards need to be placed.

Close slider

Close the slider that holds the sim card. To slide it closed, gently press against the sim slot and slide to the right with care.

Place back Hatch

Place the Hatch back onto the terminal and fasten the screws.